

Winkel-Einschraubverschraubung 90°

Bezeichnung

B-AGN 1/8
B-AGN 1/4
B-AGN 3/8-1/4
B-AGN 3/8
B-AGN 1/2-3/8
B-AGN 1/2
B-AGN 3/4-1/2
B-AGN 3/4
B-AGN 1

Aussengewinde NPT - Aussengewinde NPT

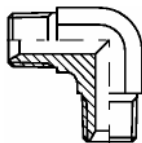

Winkel Aufschraubverschraubung 90°

Bezeichnung

B-IGN 1/8
B-IGN 1/4
B-IGN 3/8
B-IGN 1/2
B-IGN 3/4
B-IGN 1
B-IGN 1 1/4

Innengewinde NPT - Innengewinde NPT

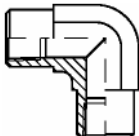

BI-AGN 1/8-1/8IGN
BI-AGN 1/4-1/4IGN
BI-AGN 1/4-3/8IGN
BI-AGN 3/8-1/4IGN
BI-AGN 3/8-3/8IGN
BI-AGN 3/8-1/2IGN
BI-AGN 1/2-1/2IGN
BI-AGN 3/4-3/4IGN
BI-AGN 1-1IGN
BI-AGN 1 1/4-1 1/4IGN

Aussengewinde NPT - Innengewinde NPT

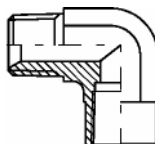

Winkel Aufschraubverschraubung 45°

Bezeichnung

Innengewinde NPT - Innengewinde NPT

B45-IGN 1/8
B45-IGN 1/4
B45-IGN 3/8
B45-IGN 1/2
B45-IGN 3/4
B45-IGN 1

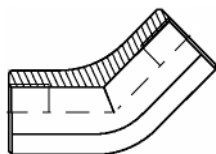

BI45-AGN 1/8-1/8IGN
BI45-AGN 1/4-1/4IGN
BI45-AGN 3/8-3/8IGN
BI45-AGN 1/2-1/2IGN

Aussengewinde NPT - Innengewinde NPT

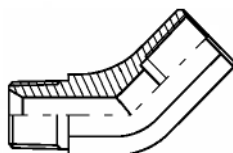

L-Einschraubverschraubung

Bezeichnung

Aussengewinde NPT - Innengewinde NPT - Innengewinde NPT

D-IGN 3/8-3/8NPT

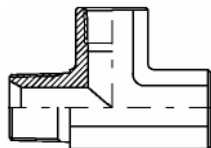

Gerade Verschraubung

Bezeichnung

E-AGN 1/8
E-AGN 1/4
E-AGN 3/8
E-AGN 1/2
E-AGN 3/4
E-AGN 1
E-AGN 1 1/4
E-AGN 1 1/2

Aussengewinde NPT - Aussengewinde NPT

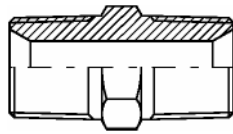

E-IGN 1/8
E-IGN 1/4
E-IGN 3/8
E-IGN 1/2
E-IGN 3/4
E-IGN 1

Innengewinde NPT - Innengewinde NPT

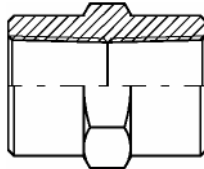

Gerade Reduzierschraubung

Bezeichnung

ER-AGN 1/4-1/8
ER-AGN 3/8-1/4
ER-AGN 1/2-1/4
ER-AGN 1/2-3/8
ER-AGN 3/4-1/2
ER-AGN 1-1/2
ER-AGN 1-3/4
ER-AGN 1 1/4-1

Aussengewinde NPT - Aussengewinde NPT

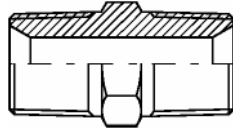

ER-IGN 3/8-1/4
ER-IGN 1/2-1/4
ER-IGN 1/2-3/8

Innengewinde NPT - Innengewinde NPT

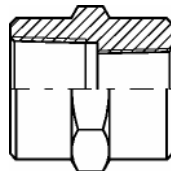

T-Verschraubung

Bezeichnung

G-IGN 1/8
G-IGN 1/4
G-IGN 3/8
G-IGN 1/2
G-IGN 3/4
G-IGN 1
G-IGN 1 1/4

Innengewinde NPT - Innengewinde NPT - Innengewinde NPT

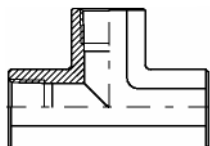

Kreuzverschraubung

Bezeichnung

H-IGN 1/8
H-IGN 1/4
H-IGN 3/8
H-IGN 1/2
H-IGN 3/4

Innengewinde NPT - Innengewinde NPT - Innengewinde NPT - Innengewinde NP

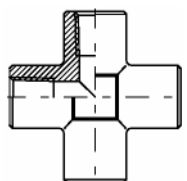

Reduzieranschlüsse

Bezeichnung

RI-AGN 1/4-1/8IGN
RI-AGN 1/4-3/8IGN
RI-AGN 3/8-1/8IGN
RI-AGN 3/8-1/4IGN
RI-AGN 1/2-1/8IGN
RI-AGN 1/2-1/4IGN
RI-AGN 1/2-3/8IGN
RI-AGN 3/4-1/4IGN
RI-AGN 3/4-3/8IGN
RI-AGN 3/4-1/2IGN
RI-AGN 1-3/8IGN
RI-AGN 1-1/2IGN
RI-AGN 1-3/4IGN
RI-AGN 1 1/4-3/4IGN
RI-AGN 1 1/4-1IGN
RI-AGN 1 1/2-3/4IGN
RI-AGN 1 1/2-1IGN
RI-AGN 1 1/2-1 1/4IGN
RI-AGN 2-1 1/4IGN

Aussengewinde NPT - Innengewinde NPT

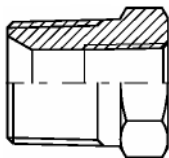

RI-AGN 3/8-IGR1/4
RI-AGN 3/8-IGR3/8
RI-AGN 1/2-IGR3/8
RI-AGN 1/2-IGR1/2
RI-AGN 3/4-IGR1/2
RI-AGN 3/4-IGR3/4
RI-AGN 1-IGR1
RI-AGN 1-IGR1 1/4

Aussengewinde NPT - Innengewinde BSP

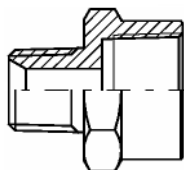

Verschlusschraube

Bezeichnung

VSCH 1/8NPT
VSCH 1/4NPT
VSCH 3/8NPT
VSCH 1/2NPT
VSCH 3/4NPT
VSCH 1NPT
VSCH 1 1/4NPT
VSCH 1 1/2NPT
VSCH 2NPT

Aussengewinde NPT

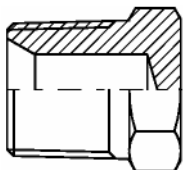

VSCH 1/8NPT ISK
VSCH 1/4NPT ISK
VSCH 3/8NPT ISK
VSCH 1/2NPT ISK
VSCH 3/4NPT ISK
VSCH 1NPT ISK
VSCH 1 1/4NPT ISK

Aussengewinde NPT

